

NOTE:

LEASE AREA CALCULATED USING PROPERTY COUNCIL OF AUSTRALIA SPECIFICATIONS FOR GROSS LETTABLE AREA (GLA)

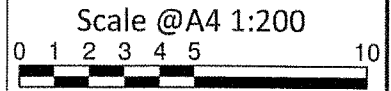
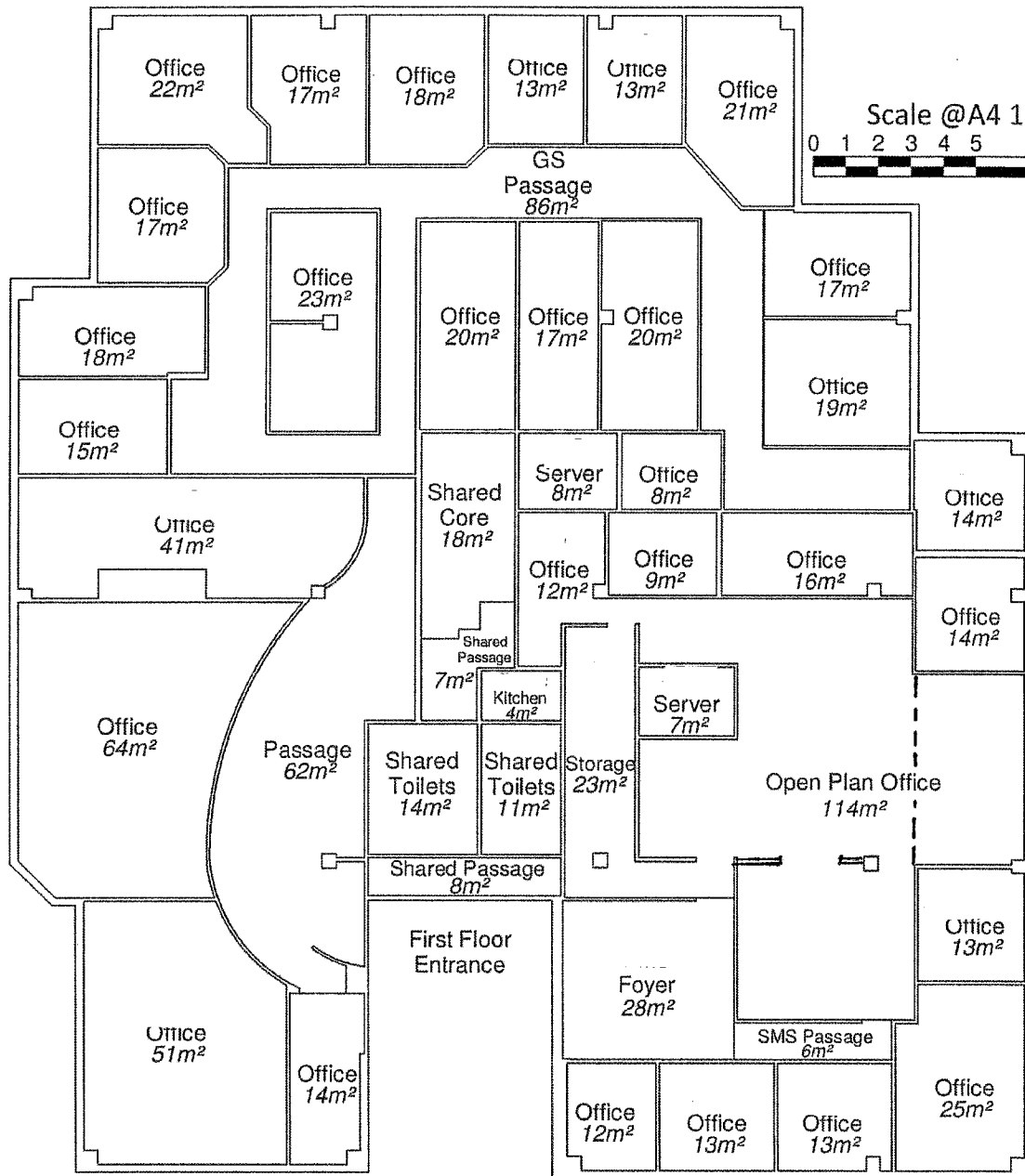

Area Schedule First Floor

Office = 462m²
 Passage/Foyer = 148m²
 Server = 8m²
 Total = 618m²

Area Schedule First Floor

Office = 241m²
 Passage/Foyer = 34m²
 Storage = 23m²
 Server = 7m²
 Total = 305m²

Area Schedule First Floor

Shared Area
 Toilets = 25m²
 Core = 18m²
 Passage = 15m²
 Kitchen = 4m²
 Total = 62m²

— = Partition modification



128 Pepler Ave. Salters Point WA 6152
 Ph: 9450 7180 Fax: 9450 7199
 email: admin@jbasurveys.com.au
 web: www.jbasurveys.com.au

097705-1.0-28052013-Local-P - LA03-Partition

CLIENT:	JOB NO: 097705	TITLE: LEASE AREA (GLA)	DATUM				
	PROJECT: LOT 58 ON D82758 183 GREAT EASTERN HIGHWAY BELMONT, WA, 6104		VERT: N/A HORIZ: Local SCALE: 1:200				
SURVEYOR: DD			DATE OF SURVEY: 28.05.2013	DRAWN BY: RMM	APPROVED BY: NRW	DWG NO: 097705-LA03	VER: 1.0
						SHEET NO: 1 OF 1	A4